

單位: ul

0,001978 最大值

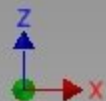

負載大小:100N

Full Compare ASTR 8 Pin-Jointed Frameworks Model 13B1 with Inventor Simulation.xls  
Left Point Loading

Pin-Jointed, Left Point Loading, 100Nf

Beam Num.	1	2	3	4	5	6	7	8	9	10	11	12	13
1st principal Strain ( $\mu\epsilon$ )		170		0	61	0				123	126	41	43
3st principal Strain ( $\mu\epsilon$ )	-183		-61				-58	-84	-84				
ASTR 8 Frame Work ( $\mu\epsilon$ )	-166	159	-56	0	56	0	-52	-74	-79	123	114	38	39

1st principal Strain ( $\mu\epsilon$ )

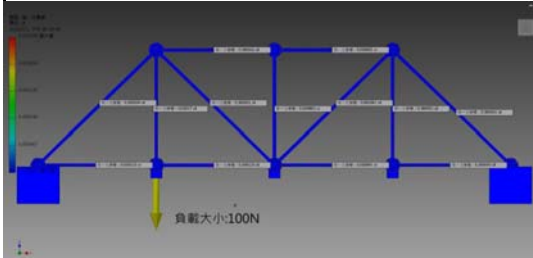

3st principal Strain ( $\mu\epsilon$ )

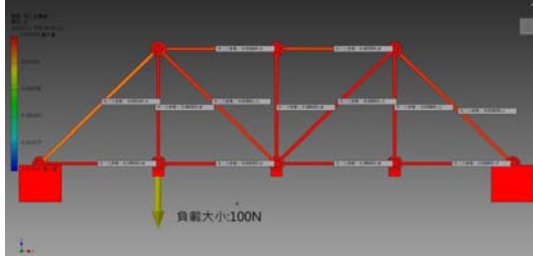

Pin-Jointed, Left Point Loading, 75 Nf

Beam Num.	1	2	3	4	5	6	7	8	9	10	11	12	13
1st principal Strain ( $\mu\epsilon$ )		127		0	45	0				93	94	31	32
3st principal Strain ( $\mu\epsilon$ )	-137		-46				-44	-63	-63				
ASTR 8 Frame Work ( $\mu\epsilon$ )	-130	128	-45	0	45	0	-42	-59	-63	98	92	31	32

1st principal Strain ( $\mu\epsilon$ )

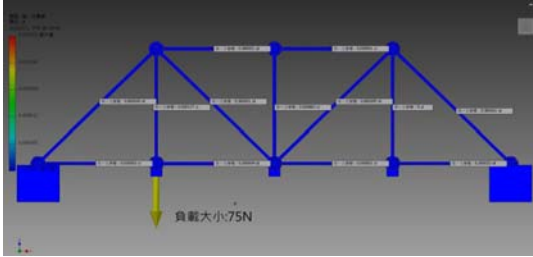

3st principal Strain ( $\mu\epsilon$ )

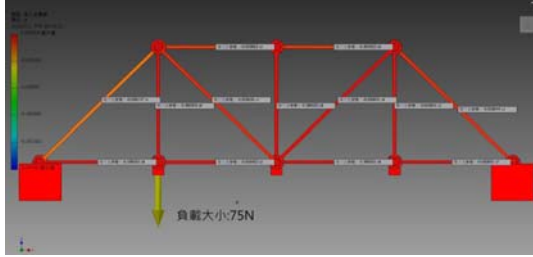

Pin-Jointed, Left Point Loading, 50 Nf

Beam Num.	1	2	3	4	5	6	7	8	9	10	11	12	13
1st principal Strain ( $\mu\epsilon$ )		85		0	30	0				62	63	21	22
3st principal Strain ( $\mu\epsilon$ )	-91.5		-30.5				-29.3	-42.2	-42.1				
ASTR 8 Frame Work ( $\mu\epsilon$ )	-96	89	-32	0	32	0	-29	-41	-44	70	64	22	22

1st principal Strain ( $\mu\epsilon$ )

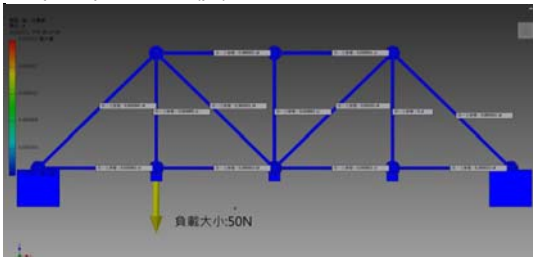

3st principal Strain ( $\mu\epsilon$ )

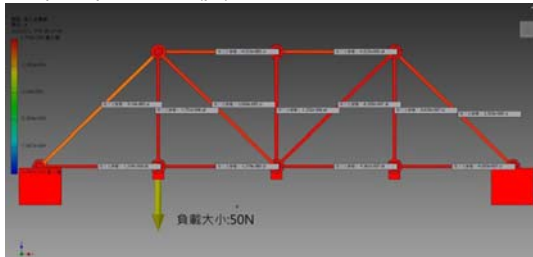

Pin-Jointed, Left Point Loading, 25 Nf

Beam Num.	1	2	3	4	5	6	7	8	9	10	11	12	13
1st principal Strain ( $\mu\epsilon$ )		42.4		0	15.2	0				30.8	31.4	10.3	10.8
3st principal Strain ( $\mu\epsilon$ )	-45.8		-15.2				-14.6	-21.1	-21.1				
ASTR 8 Frame Work ( $\mu\epsilon$ )	-50	46	-16	0	16	0	-15	-21	-22	36	34	11	12

1st principal Strain ( $\mu\epsilon$ )

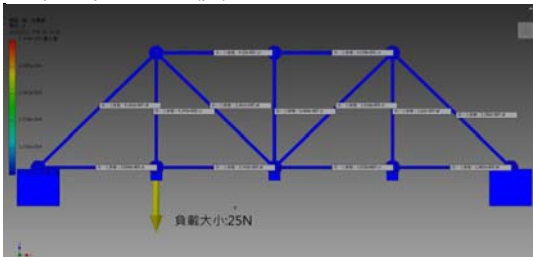

3st principal Strain ( $\mu\epsilon$ )

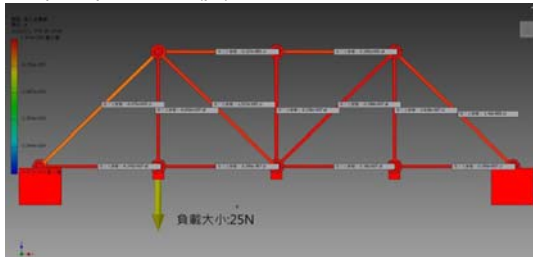

Full Compare ASTR 8 Pin-Jointed Frameworks Model 13B1 with Inventor Simulation.xls  
Middle Point Loading

Pin-Jointed, Middle Point Loading, 100Nf

Beam Num.	1	2	3	4	5	6	7	8	9	10	11	12	13
1st principal Strain ( $\mu\epsilon$ )		0	123	0	121	0				83	83	82	86
3st principal Strain ( $\mu\epsilon$ )	-123						-117	-170	-169				
ASTR 8 Frame Work ( $\mu\epsilon$ )	-116	1	116	1	115	0	-106	-152	-157	79	78	76	79

1st principal Strain ( $\mu\epsilon$ )

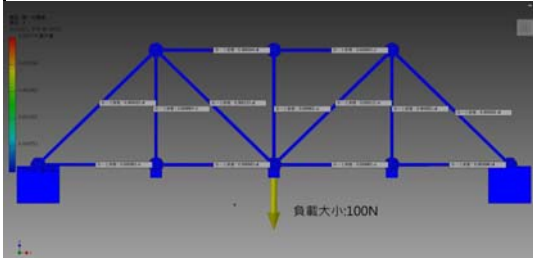

3st principal Strain ( $\mu\epsilon$ )

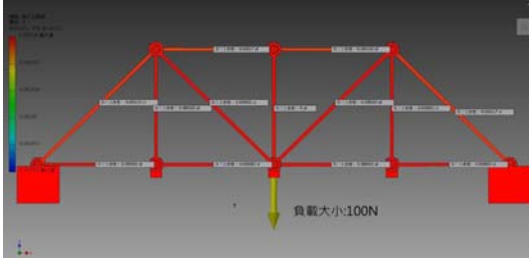

Pin-Jointed Point, Middle Loading, 75Nf

Beam Num.	1	2	3	4	5	6	7	8	9	10	11	12	13
1st principal Strain ( $\mu\epsilon$ )		0	92	0	91	0				62	62	61	65
3st principal Strain ( $\mu\epsilon$ )	-92						-88	-128	-127				
ASTR 8 Frame Work ( $\mu\epsilon$ )	-94	0	91	0	91	0	-84	-120	-125	60	61	60	64

1st principal Strain ( $\mu\epsilon$ )

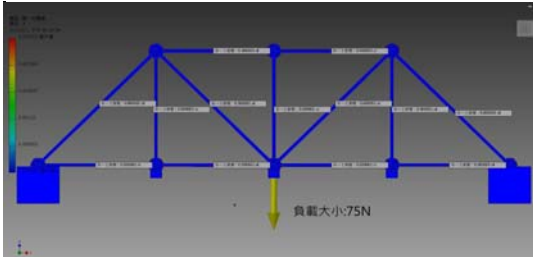

3st principal Strain ( $\mu\epsilon$ )

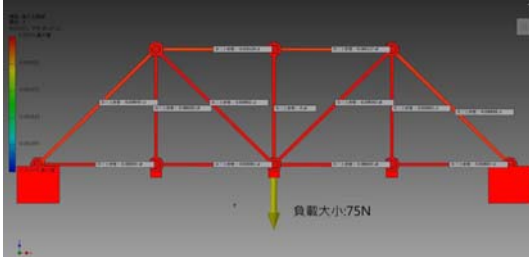

Pin-Jointed, Middle Point Loading, 50Nf

Beam Num.	1	2	3	4	5	6	7	8	9	10	11	12	13
1st principal Strain ( $\mu\epsilon$ )		0	61	0	60	0				41	42	41	43
3st principal Strain ( $\mu\epsilon$ )	-61						-58	-85	-84				
ASTR 8 Frame Work ( $\mu\epsilon$ )	-69	-1	64	-2	62	-3	-64	-89	-89	44	44	43	45

1st principal Strain ( $\mu\epsilon$ )

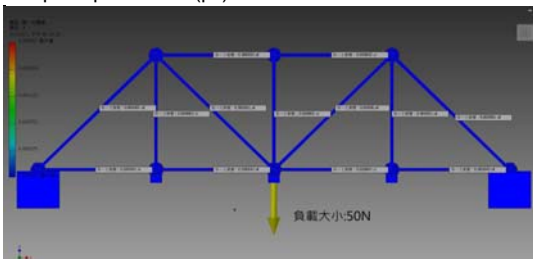

3st principal Strain ( $\mu\epsilon$ )

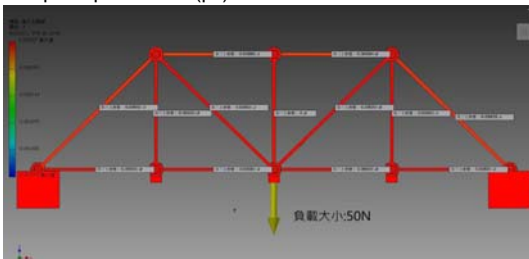

Pin-Jointed, Middle Point Loading, 25Nf

Beam Num.	1	2	3	4	5	6	7	8	9	10	11	12	13
1st principal Strain ( $\mu\epsilon$ )		0	30.7	0	30.2	0				20.7	20.8	20.4	21.6
3st principal Strain ( $\mu\epsilon$ )	-30.7						-29.2	-42.6	-42.2				
ASTR 8 Frame Work ( $\mu\epsilon$ )	-36	-1	33	-1	33	-1	-32	-46	-47	22	22	22	23

1st principal Strain ( $\mu\epsilon$ )

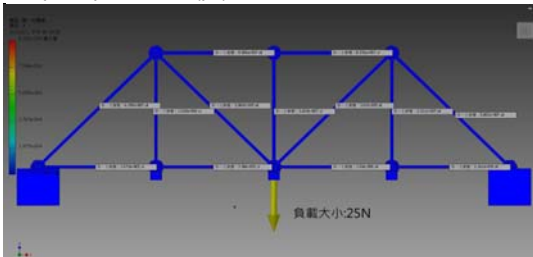

3st principal Strain ( $\mu\epsilon$ )

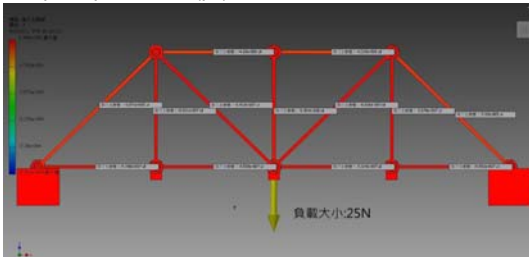

Full Compare ASTR 8 Pin-Jointed Frameworks Model 13B1 with Inventor Simulation.xls  
Right Point Loading

Pin-Jointed, Right Point Loading, 100Nf

Beam Num.	1	2	3	4	5	6	7	8	9	10	11	12	13
1st principal Strain ( $\mu\epsilon$ )		0	62	0		169				41	42	126	129
3st principal Strain ( $\mu\epsilon$ )	-62				-61		-177	-85	-85				
ASTR 8 Frame Work ( $\mu\epsilon$ )	-57	0	58	0	-56	164	-152	-74	-78	31	29	105	108

1st principal Strain ( $\mu\epsilon$ )

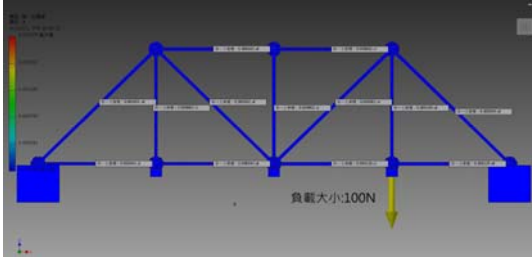

3st principal Strain ( $\mu\epsilon$ )

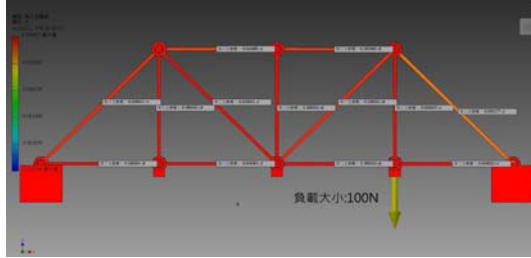

Left Pin-Jointed, Right Point Loading, 75Nf

Beam Num.	1	2	3	4	5	6	7	8	9	10	11	12	13
1st principal Strain ( $\mu\epsilon$ )		0	46	0		126				31	31	95	97
3st principal Strain ( $\mu\epsilon$ )	-46				-45		-133	-64	-64				
ASTR 8 Frame Work ( $\mu\epsilon$ )	-45	0	45	0	-45	131	-124	-60	-62	20	19	79	82

1st principal Strain ( $\mu\epsilon$ )

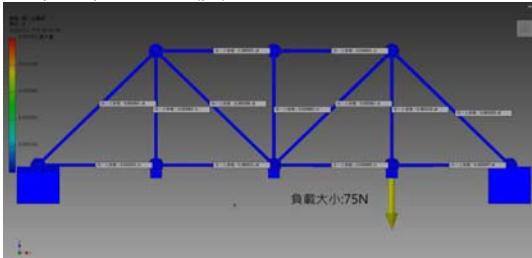

3st principal Strain ( $\mu\epsilon$ )

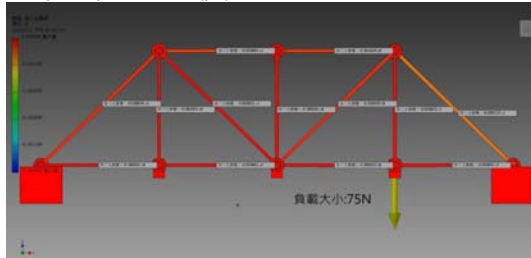

Pin-Jointed, Right Point Loading, 50Nf

Beam Num.	1	2	3	4	5	6	7	8	9	10	11	12	13
1st principal Strain ( $\mu\epsilon$ )		0	30.9	0		84.3				20.7	21	63.2	64.4
3st principal Strain ( $\mu\epsilon$ )	-30.9				-30.3		-88.4	-42.6	-42.5				
ASTR 8 Frame Work ( $\mu\epsilon$ )	-32	0	32	0	-31	93	-88	-42	-44	18	17	61	62

1st principal Strain ( $\mu\epsilon$ )

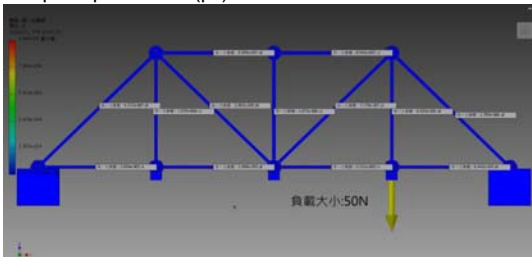

3st principal Strain ( $\mu\epsilon$ )

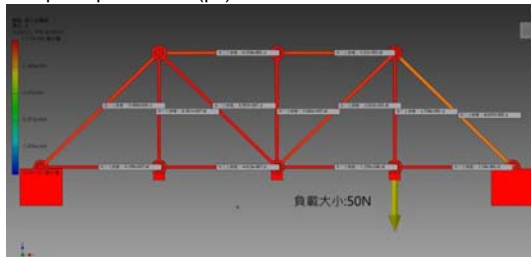

Pin-Jointed, Right Point Loading, 25Nf

Beam Num.	1	2	3	4	5	6	7	8	9	10	11	12	13
1st principal Strain ( $\mu\epsilon$ )		0	15.5	0		42.2				10.3	10.5	31.6	32.2
3st principal Strain ( $\mu\epsilon$ )	-15.5				-15.2		-44.2	-21.3	-21.3				
ASTR 8 Frame Work ( $\mu\epsilon$ )	-16	0	16	0	-16	47	-45	-21	-22	10	9	32	32

1st principal Strain ( $\mu\epsilon$ )

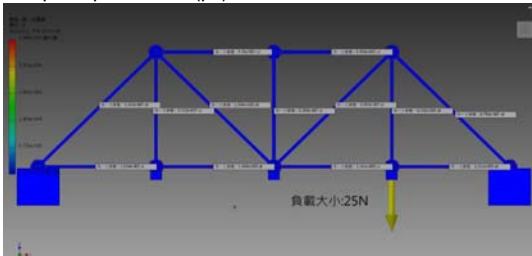

3st principal Strain ( $\mu\epsilon$ )

